

[Go Back](#)

# Urban Rain Barrel Assembly Instructions

Please be sure and read our [Product Information](#) page for additional information on setting up the URB and its proper use.

## Assembly Instructions for the Urban Rain Barrel

### PARTS

- |                          |   |
|--------------------------|---|
| (1) 55 Gal. Rain Barrel  | (1) Shut-off Valve                        |
| (1) Male Coupling        | (1) 5' Length of Corrugated Overflow Hose |
| (1) Female Coupling      | (1) All Purpose Glue                      |
| (1) 10" PVC Pipe         | (1) "Econo Plug"                          |
| (2) Black Rubber Gaskets |   |
| (2) 90° Plastic Elbows   |   |

Cut plastic tie wrap (around wood piece) and remove all parts from inside the barrel. Check all parts and make sure all quantities are correct. For single barrel application, the overflow drain spout may be placed on either side of the barrel depending where you want the hose to direct overflowing water to go. Installation will be discussed in detail in Step 7.

### Step 1.

Take the 1-1/2" Male Connector and place black gasket on threaded portion of the sleeve.

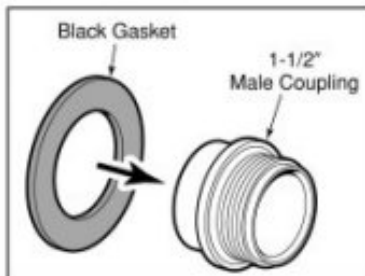

### Step 2.

From inside the barrel, screw the 1-1/2" Male Coupling through one of the holes on the side of the barrel.

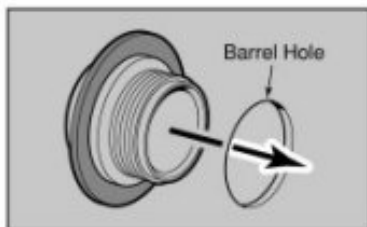

### Step 3.

Place second gasket on 1-1/2" Male Coupling that is facing outside the barrel.

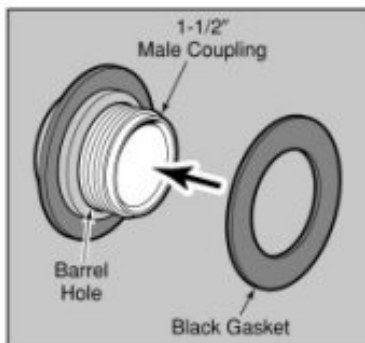

### Step 4.

Screw Female Coupling



### Step 5.

Using the All Purpose Glue provided, glue 10" PVC Pipe into the 90° elbow, (when gluing parts, be sure to always apply glue to both sections that you are assembling.) Glue 90° elbow to the Male Coupling inside the barrel. (the 10" PVC Pipe should be straight up and down.)

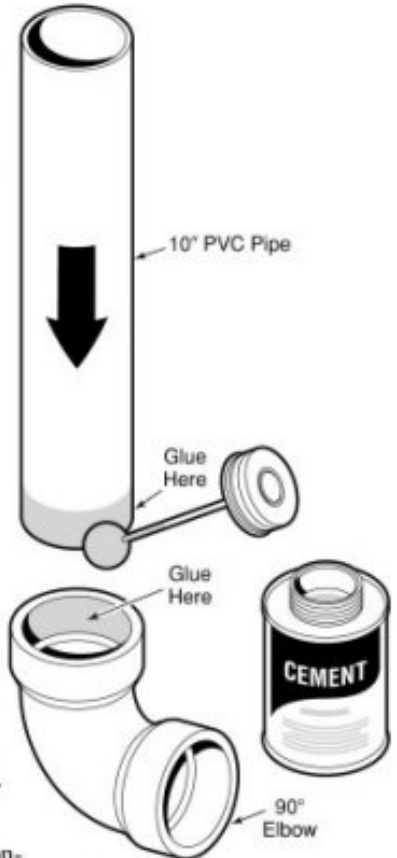

### Step 6.

For single barrel application, take the other 90 degree elbow and place on the 1-1/2" Female Coupling on the outside of the barrel (do not glue) so that corrugated hose position can be redirected as desired. Take the other 1-1/2" Male Threaded Coupling and glue the non-

threaded end into the other 90 degree elbow (let set for 30 seconds). Take the 5' corrugated hose and apply glue to both the hose and the inside of the coupling, be sure the corrugated hose is pushed all the way into the coupling (let set also for 30 seconds).

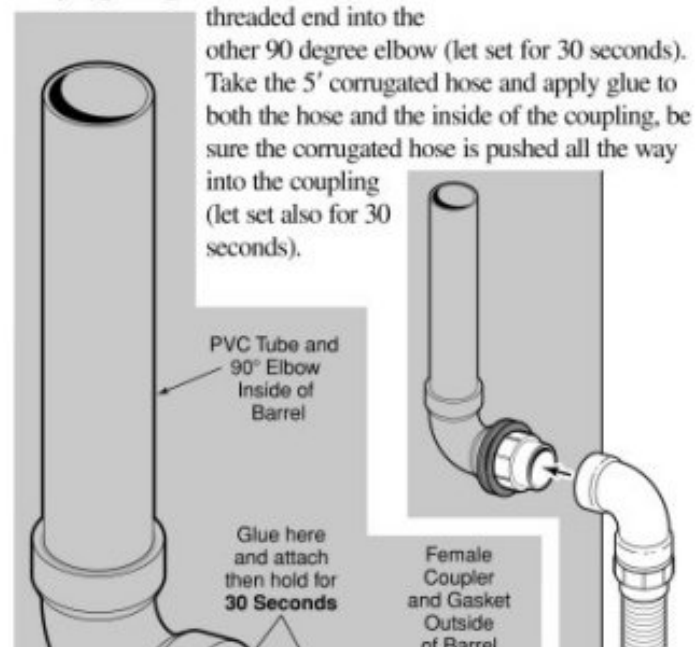

Screw Female Coupling on threaded portion of the Male Coupling and tighten with a pair of channel locks (do not overtighten). Fill with water and check for any leakage.

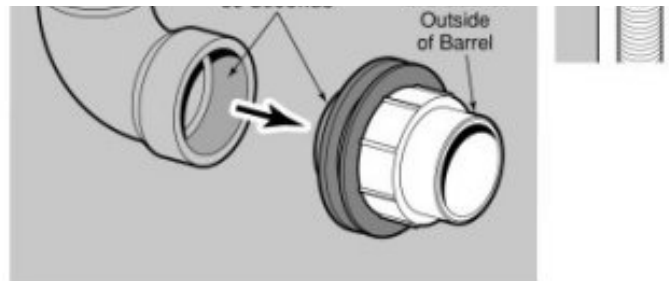
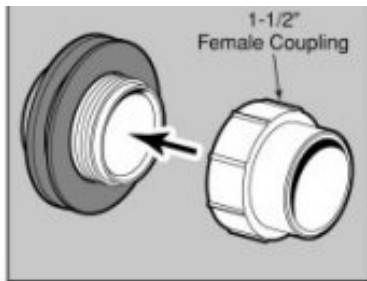

## Assembly Instructions for the Urban Rain Barrel Continued

### Step 7.

Now you ready to install the "Econo Plug" into the Rain Barrel. First you unscrew the wing nut so the plug rubber will contract and will become very pliable and elongated. Take the plug and shove firmly into the 1-1/2" entry hole making sure all the rubber is on the inside of the barrel and is well seated. Start screwing the wing nut clockwise so the plug will expand and seat properly. Test barrel again by adding water to search again for any leakage.

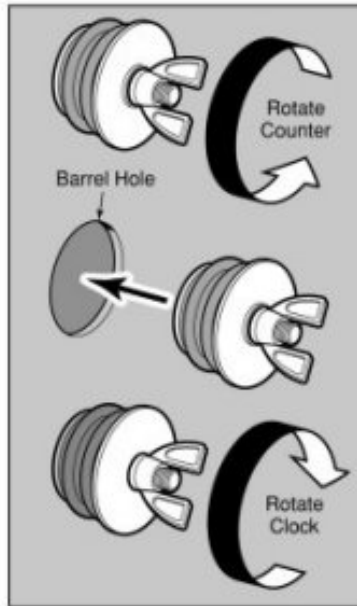

### Step 8.

For the "Sealed Lid" Downspout connection first you must determine the length needed to reach the Rain Barrel from your gutter downspout. To do this, measure the length from the downspout that is coming from the gutter and attached to your house wall to determine where you are going to cut the downspout off and insert the 90 degree elbow (A). Then measure the distance

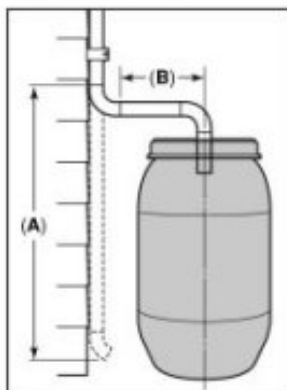

from the 90 degree elbow to the center of the barrel opening (B). This distance will establish where you



### Step 9.

Thread the Shut-Off Valve onto the brass nipple at the base of the Rain Barrel. Attach your garden hose to the valve.

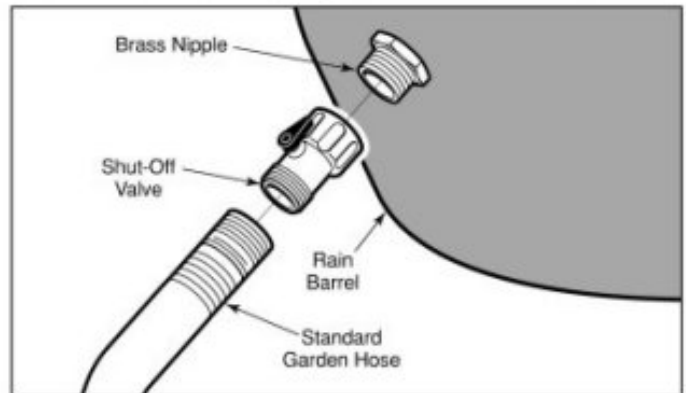

### 2 Barrel Configuration

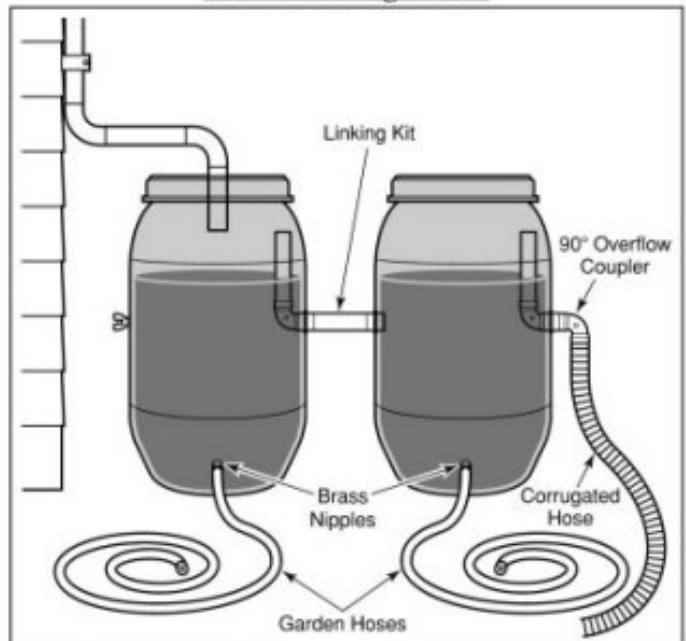

You will need one "Linking Kit" per Rain Barrel.

### Cleaning Tips:

Every now and then pour a little Iodine into the Rain Barrel, it will keep the barrel free of unwanted things, but keep the good things.

**D&P Industries Inc.**

Sales and Service: (503) 286-9866

opening (**B**). This distance will establish where you will put the other 90 degree elbow plus a small piece of downspout that will fit into the Rain Barrel.



**DEE INDUSTRIES INC.**  
**Sales and Service: (503) 286-9866**

**Return to [TOP](#)**

[Go Back](#)